

Rear Light - Installation

WARNING

Before starting work, ensure the motorcycle is stabilised and adequately supported. This will help prevent it from falling and causing injury to the operator or damage to the motorcycle.

1. Fit the rear light to the rear light bracket and tighten the three fixings to **2 Nm**.
2. Route the harness as noted for removal and attach the rear light harness to its clip on the rear light bracket.

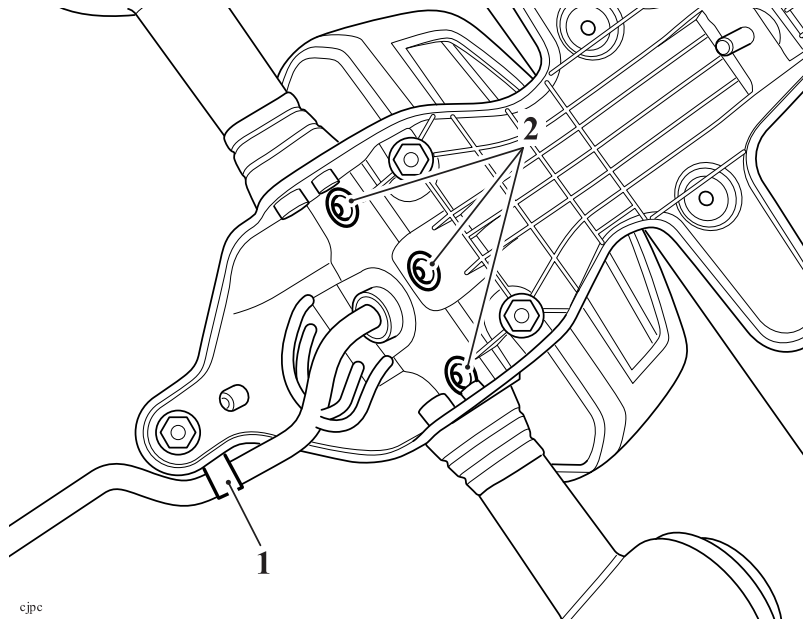

1. **Harness clip**
2. **Fixings**

3. Refit the rear light cover and tighten its two fixings to **2 Nm**.

Note

- **The harness for the right hand direction indicator can be identified by the red tape on it.**
4. Route the direction indicator harness as noted for removal and connect the electrical connectors to the rear light harness.

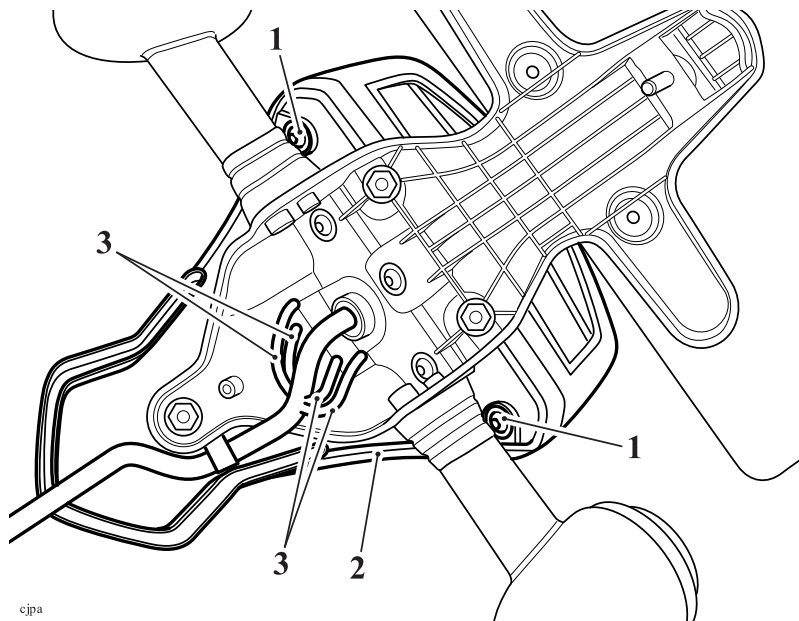

1. Fixings
2. Rear light cover
3. Direction indicator harnesses

5. Fit the harness cover and tighten its fixings to **4 Nm**.

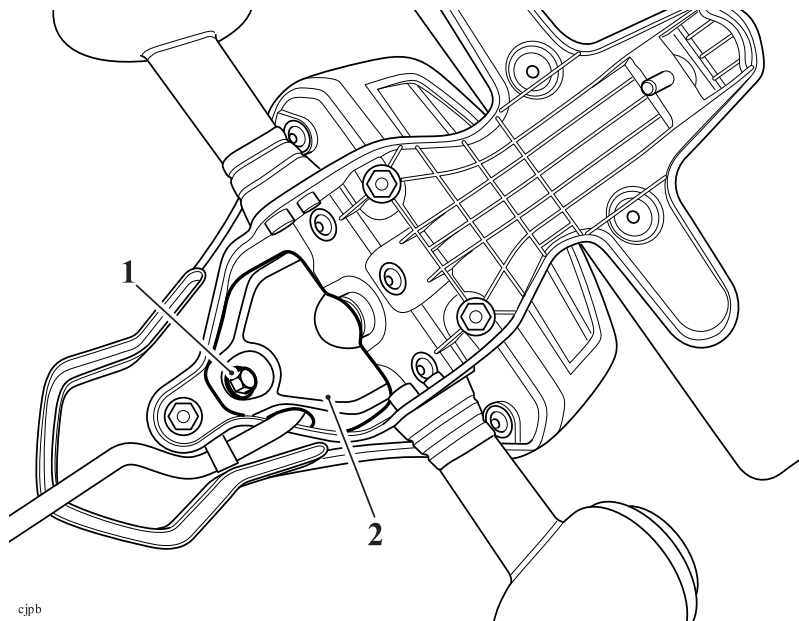

1. Fixings
2. Harness cover

6. Refit the rear light to the rear mudguard and tighten the new fixings to **5 Nm**.

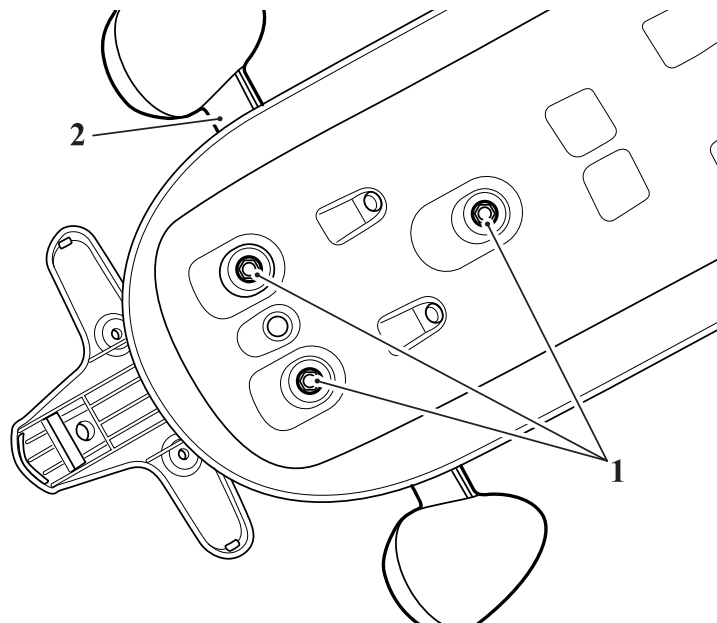

- 1. Fixings**
- 2. Rear light assembly**

7. Refit the rear mudguard (see [Rear Mudguard - Installation](#)).
- Reconnect the battery, positive (red) lead first (see [Battery - Installation](#)) and tighten the terminals to **4.5 Nm**.
- Refit the seat (see [Seat - Installation](#)).
- Check the rear light operation, rectify as necessary.